

REVISION	CHANGE	APPROVED	DATE
1	Published release	JTS	26/11/2025

ASI-4-2-2

PRE-FITTING ADAPTER ASSEMBLY TO HUB

PROCEDURE

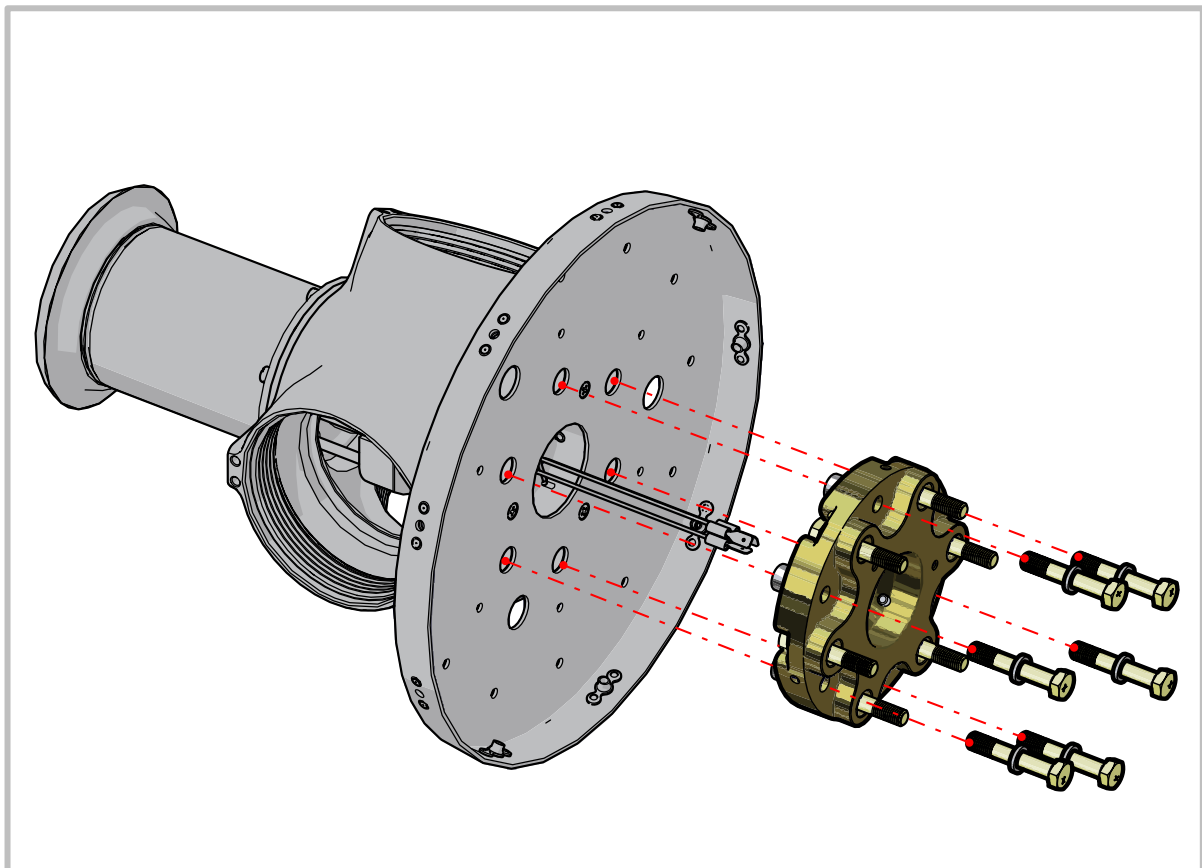

SUBJECT:

Mount Kit Installation

ASSEMBLY NO:

AE-xAx

APPLICABILITY:

All propeller models using an
adapter kit assembly

1. TOPIC



1.1 Introduction

This document covers the procedure for fitting an Airmaster adapter kit assembly to the propeller hub. Installers must complete this task before mounting the hub to the engine flange.



Some adapter assemblies incorporate electrical wiring (such as when a standard slipring is used with the propeller) while others do not (such as when a mini slipring is used with the propeller). Installers should follow the steps applicable for their specific setup.

2. MATERIAL REQUIREMENTS





2.1 Parts

ITEM	QTY	PART NO.	DESCRIPTION	IMAGE
1.	1	AE-xAx	Airmaster Adapter Kit Assembly	
2.	1	AH-xxx	Airmaster Hub Assembly	

2.2 Tooling

ITEM	QTY	DESCRIPTION	IMAGE
1.	As required	Heat Gun	
2.	1	Torque Wrench (1/2" Socket) *Size requirements may vary	

2.3 Consumables

ITEM	QTY	DESCRIPTION	IMAGE
1.	As required	Anti-Seize Compound (Paste) (e.g. Duralac, Tef-Gel, Loctite® Moly-50)	
2.	As required	Cleaning Agent (Non-Corrosive) (e.g. Loctite® SF 7063, Methylated Spirits)	
3.	As required	Paper Towels, Clean Cloth (or similar)	
4.	As required	Brush	
5.	As required	Torque-Seal	

2.4 Paperwork

ITEM	QTY	CODE	DESCRIPTION
1.	1	AE-xAx	Airmaster Adapter Kit Assembly Drawing & BoM
2.	1	AH-xxx	Airmaster Hub Assembly Drawing & BoM
3.	1	As applicable	Control System Circuit Diagram

2.5 PPE

ITEM	QTY	DESCRIPTION	IMAGE
1.	As required	Protective Gloves	

3. PROCEDURE

3.1 Preparation

PROCEDURE

Step 1 Prepare Hub / Backplate

- Carefully rest propeller hub on motor cap (upside down) atop a flat, clean surface.
- Clean mounting face of spinner backplate and inspect this area for damage or defect.

Caution

Take care not to topple the hub. A temporary hub cradle may be fashioned using a piece of custom wood with a 100mm diameter, circle in the centre and supporting legs.

Attention Cleaning agent, Paper towels

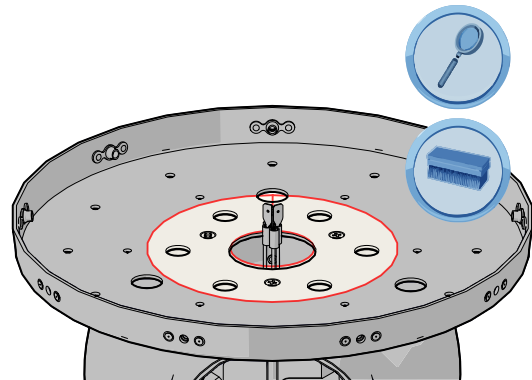

Step 2 Prepare Adapter Assembly

- Clean mounting face (spigot-side) of adapter assembly.
- Inspect assembly for damage or defect.

Attention Cleaning agent, Paper towels

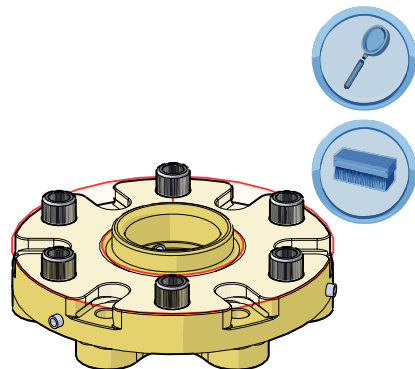

Step 3 Lubricate Adapter Drive Lugs

- Apply a light film of anti-seize compound to the adapter assembly drive lugs for corrosion protection.

⚠ Caution See approved anti-seize compounds.

🕒 Attention Anti-seize compound, Brush

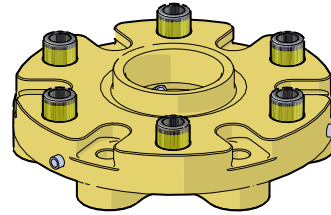

Step 4 Insert Flange Mounting Bolts

- Insert (6) flange mounting bolts with Nord-Lock® washer pairs through the adapter assembly drive lugs (from hub-side).

⚠ Caution
Ensure no jointing compound transfers to the bolt threads, these must remain clean and dry for correct clamping.

📌 Note
Refer to correct use of Nord-Lock® washers.

📌 Note
These bolts can't be inserted once the adapter is subsequently fitted to the propeller hub.

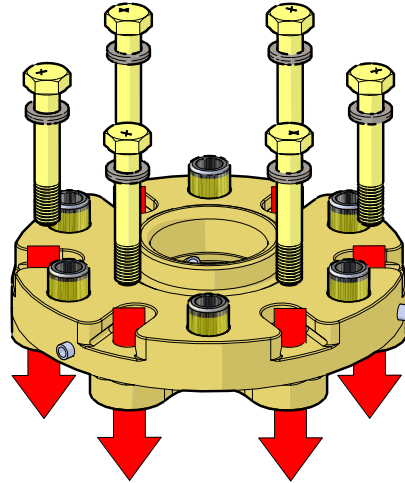

3.2 Connect Wiring (As Required)

📌 Note This task only applies when a wired adapter assembly is used.

PROCEDURE

Step 1 Connect Hub Wiring

- Slide a 50mm tube of heat shrink (P2041-50) over each hub wire.
- Connect hub and adapter assembly spade terminals of matching wire colour.

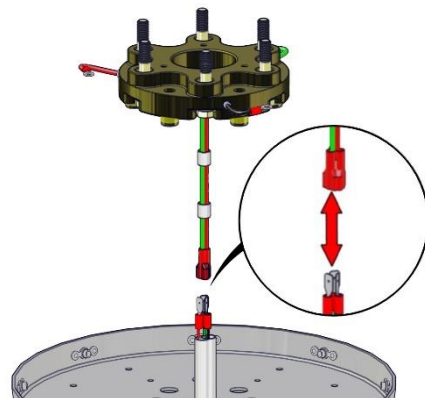

Step 2 Secure Heat Shrink

- Slide heat shrink tubes over terminal connections.
- Shrink the tubes in place.

⚠ Caution

Take care not to apply excessive or prolonged heat as this can melt the wire insulation.

ⓘ Attention Heat gun

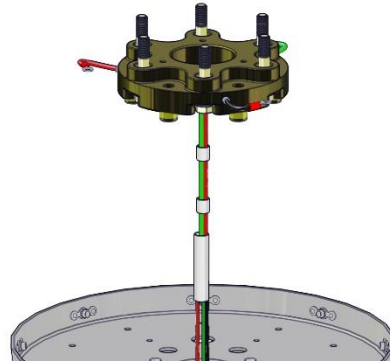

3.3 Fit Adapter Assembly to Hub

PROCEDURE

Step 1 Locate Adapter into Hub

- Locate adapter assembly drive lugs into hub mounting holes and push into place.

ⓘ Note

For wired adapter kits:

- Align black adapter wire with hub port 1.
- Arrange loose wiring into the centre recess to prevent obstruction between mating faces.

- Check adapter assembly is seated square with backplate.

**Showing Non-Wired Adapter Assembly*

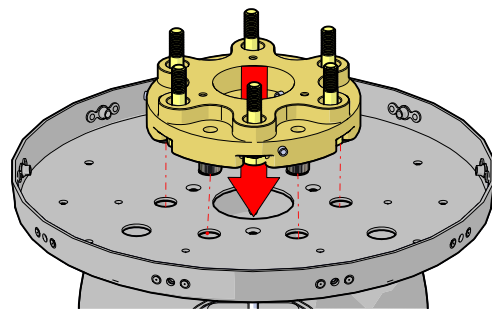

Step 2 Attach Adapter to Hub

- Attach adapter assembly to hub with (6) hub mounting bolts and Nord-Lock® washer pairs hand tight.

ⓘ Note

Refer to correct use of Nord-Lock® washers.

**Showing Non-Wired Adapter Assembly*

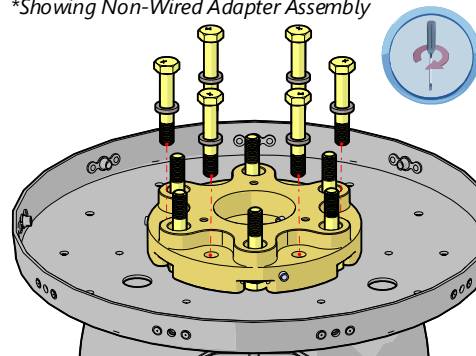

Step 3 Torque Hub Mounting Bolts

- Torque hub mounting bolts in increments and in sequence of opposing pairs.

BOLT SIZE	TORQUE [NM]	TORQUE [FT-LBS]
AN5 (5/16in or M8)	24	18
AN6 (3/8in)	42	31
AN7 (7/16in)	66	49
AN8 (1/2in)	103	76

- Indicate with torque-seal.

Caution

Do not over-tighten bolts as this may damage the hub threaded inserts.

Attention

Torque Wrench (size requirements vary), Torque-seal

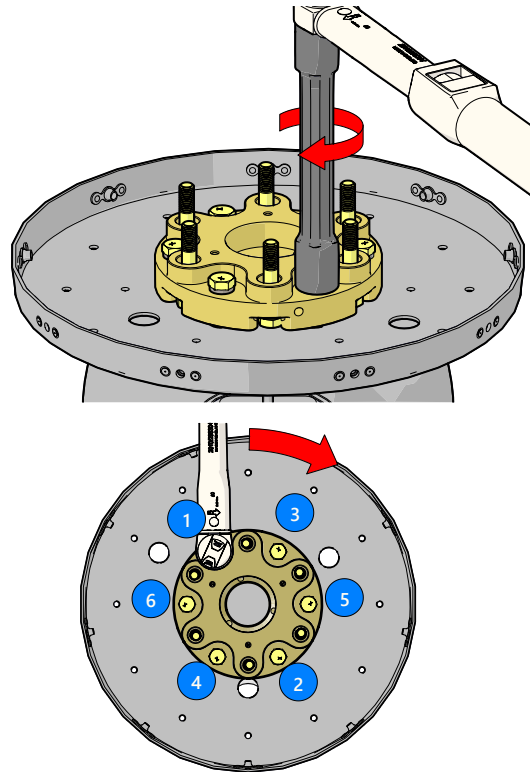

3.4 Subsequent Action

Perform the following tasks once this procedure is complete:

- If applicable, attach standard slipring assembly to plated adapter assembly in accordance with procedure **ASI-4-3-2-3**.
- If applicable, install mini slipring assembly in accordance with procedure **ASI-4-3-1**.
- Mount hub to engine flange in accordance with procedure **ASI-4-4-3**.